

COUNTY OF KINGS HIGHWAY SAFETY IMPROVEMENT PROJECT (HSIP) CYCLE 10

FLASHING BEACONS AT VARIOUS LOCATIONS PROJECT NO. HSIPSL-5945(117)

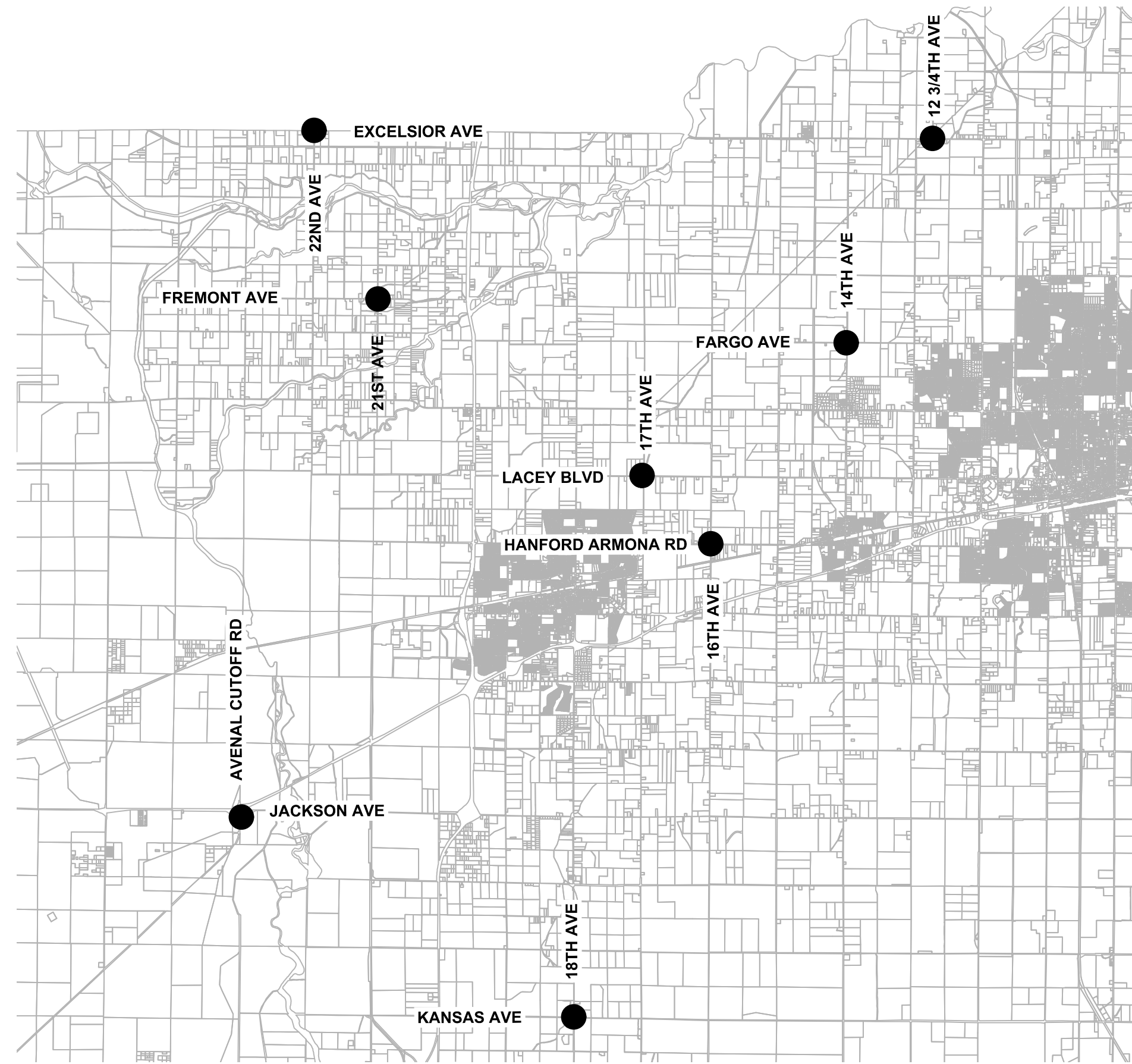

LOCATION & INDEX MAP

NOT TO SCALE

● PROJECT LOCATIONS

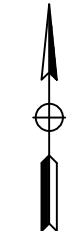

GENERAL NOTES

- ALL IMPROVEMENTS SHALL BE AS PER CURRENT COUNTY OF KINGS ENGINEERING IMPROVEMENT STANDARDS & SPECIFICATIONS AND THE LATEST REVISED 2022 EDITION OF THE STATE OF CALIFORNIA DEPARTMENT OF TRANSPORTATION STANDARD PLANS & SPECIFICATIONS.
- THE CONTRACTORS SHALL BE LICENSED AS A CLASS "A" GENERAL ENGINEERING CONTRACTOR AND ALL SUB-CONTRACTORS SHALL POSSESS THE APPROPRIATE CLASS "B" OR "C" OR OTHER SPECIALTY LICENSE AS REQUIRED BY THE CATEGORY OF WORK TO BE PERFORMED IN ACCORDANCE WITH THE PROVISIONS OF CHAPTER 9, DIVISION 3 OF THE BUSINESS AND PROFESSIONS CODE.
- THE CONTRACTOR SHALL IMMEDIATELY NOTIFY THE ENGINEER OF ANY AND ALL CONFLICTS BETWEEN CONTRACT DOCUMENTS AND THE ACTUAL SITE CONDITIONS PRIOR TO COMMENCING WORK IN ANY GIVEN AREA AND ALLOW TIME FOR THE ENGINEER TO ISSUE RESOLUTION TO ANY PROPOSED CONFLICTS. THE CONTRACTOR SHALL CONTINUE WORK IN OTHER AREAS OF THE PROJECT WITHOUT SUCH CONFLICTS UNTIL THE ENGINEER HAS ISSUES RESOLUTION BY CHANGE ORDER OR OTHER PROJECT APPROVED LINES OF COMMUNICATION.
- SHOULD IT APPEAR THAT THE WORK TO BE DONE OR ANY MATTER RELATIVE HERETO IS NOT SUFFICIENTLY DETAILED OR EXPLAINED ON THESE PLANS, THE CONTRACTOR SHALL CONTACT THE COUNTY OF KINGS AT (559) 852-2601 FOR SUCH FURTHER EXPLANATIONS AS MAY BE NECESSARY.
- UNAUTHORIZED CHANGES AND USES: THE ENGINEER PREPARING THESE PLANS SHALL NOT BE RESPONSIBLE FOR, OR LIABLE FOR, UNAUTHORIZED CHANGES TO OR USES OF THESE PLANS BY OTHERS. THE CONTRACTOR SHALL SUBMIT TO THE ENGINEER ANY PROPOSED MODIFICATIONS AND/OR CHANGES TO THE PLANS AND SPECIFICATIONS IN WRITING WITH SUFFICIENT DETAILED INFORMATION AND TIME TO ALLOW THE ENGINEER TO CONDUCT AN ANALYSIS OF THE PROPOSED CHANGE AND PREPARE A WRITTEN RESPONSE TO THE CONTRACTOR. APPROVED CHANGES AND/OR MODIFICATIONS TO THE PLANS AND SPECIFICATIONS SHALL BE ISSUED BY THE ENGINEER AS CHANGE ORDERS.
- THESE PLANS ARE THE PROPERTY AND COPYRIGHT OF THE ENGINEER AND SHALL NOT BE USED ON ANY OTHER WORK EXCEPT BY WRITTEN AGREEMENT WITH THE ENGINEER. WRITTEN DIMENSIONS SHALL TAKE PRECEDENCE OVER SCALED DIMENSIONS AND FIELD DIMENSIONS SHALL BE VERIFIED ON THE JOB SITE. ANY DISCREPANCY SHALL BE BROUGHT TO THE ATTENTION OF THE ENGINEER PRIOR TO THE START OF ANY WORK.
- CONTRACTOR SHALL PROVIDE PEDESTRIAN, VEHICLE, WORKER AND TREE PROTECTION AS NECESSARY FOR THE FULL DURATION OF THE PROJECT.
- CONTRACTOR SHALL INSTALL APPROVED TRAFFIC CONTROL SIGNS PRIOR TO COMMENCEMENT OF ANY WORK INCLUDING ALL LIGHTS, SIGNS, BARRICADES, FLAGMEN OR OTHER DEVICES NECESSARY TO PROVIDE FOR SAFETY.
- CONTRACTOR SHALL MAINTAIN DUST CONTROL ABOUT THE SITE OF WORK. THE CONTRACTOR SHALL BE RESPONSIBLE FOR ANY DAMAGE OR OTHER CONSEQUENCES RESULTING FROM HIS FAILURE TO DO SO.
- CONTRACTOR SHALL NOTIFY THE APPROPRIATE AGENCY AT LEAST 10 WORKING DAYS PRIOR TO COMMENCING WORK SO THAT SAID AGENCY MAY PRESERVE SURVEY MONUMENTS AND BENCHMARKS, WHICH MAY NOT BE DISTURBED WITHOUT AGENCY CONSENT. THE CONTRACTOR SHALL BE RESPONSIBLE FOR REPLACING DESTROYED BENCHMARKS AND SURVEY MONUMENTS. THIS WORK SHALL BE DONE UNDER THE SUPERVISION OF A LICENSED SURVEYOR.
- CONTRACTOR SHALL PRESERVE ALL CONSTRUCTION SURVEY STAKES AND PROPERTY LINE MARKERS WHEN REASONABLY POSSIBLE. ANY STAKES OR MARKERS REQUIRING REPLACEMENT BY THE ENGINEER SHALL BE DONE AS "EXTRA WORK."
- CONTRACTOR IS RESPONSIBLE FOR OBTAINING ALL PERMITS & INSPECTIONS. ANY INSPECTION TO BE PERFORMED BY THE COUNTY SHALL REQUIRE A 48-HOUR NOTICE.
- CONTRACTOR SHALL NOTIFY THE APPROPRIATE PERMIT AGENCY AT LEAST 10 WORKING DAYS PRIOR TO COMMENCING WORK AND SHALL CONDUCT ALL WORK IN ACCORDANCE WITH THE PERMITS AND/OR SPECIAL CONDITIONS AS ISSUED BY THE AGENCY OR UTILITY COMPANY INVOLVED.
- CONTRACTOR SHALL NOTIFY ENGINEER 3 WORKING DAYS (MIN.) PRIOR TO WORK REQUIRING STAKING FOR PROPER SCHEDULING.
- EXISTING UNDERGROUND UTILITIES AND IMPROVEMENTS ARE SHOWN IN THEIR APPROXIMATE LOCATIONS BASED UPON RECORD INFORMATION AVAILABLE TO THE ENGINEER AT THE TIME OF PREPARATION OF THESE PLANS. LOCATIONS MAY NOT HAVE BEEN VERIFIED IN THE FIELD AND NO GUARANTEE IS MADE AS TO THE ACCURACY OR COMPLETENESS OF THE INFORMATION SHOWN.
- THE CONTRACTOR SHALL NOTIFY THE OWNER & UTILITY COMPANIES AT LEAST 2 WORKING DAYS IN ADVANCE OF CONSTRUCTION TO FIELD LOCATED UTILITIES. CALL "UNDERGROUND SERVICE ALERT" (U.S.A.) AT 1-800-227-2600 OR 811. IT SHALL BE THE RESPONSIBILITY OF THE CONTRACTOR TO DETERMINE THE EXISTENCE AND LOCATION OF THOSE UTILITIES SHOWN ON THESE PLANS OR INDICATED IN THE FIELD BY LOCATION SERVICES. ANY ADDITIONAL COSTS INCURRED AS A RESULT OF THE CONTRACTOR'S FAILURE TO VERIFY LOCATIONS OF EXISTING UTILITIES PRIOR TO BEGINNING OF CONSTRUCTION IN THEIR VICINITY SHALL BE BORNE BY THE CONTRACTOR AND ASSUMED INCLUDED AND MERGED IN THE CONTRACT UNIT PRICE.

SIGNING AND STRIPING GENERAL NOTES

- TRAFFIC SIGNING AND STRIPING, AND THE INSTALLATION THEREOF SHALL CONFORM TO CALTRANS LATEST REVISED STANDARD PLANS AND SPECIFICATIONS, DATED 2022, THE 2014 CALIFORNIA MANUAL ON UNIFORM TRAFFIC CONTROL DEVICES (CA MUTCD), LATEST EDITION, THIS PLAN AND THE SPECIAL PROVISIONS. THE CONTRACTOR SHALL VERIFY THE INFORMATION SHOWN ON THESE PLANS WITH THE REFERENCED DOCUMENTS AND NOTIFY THE COUNTY OF KINGS OF ANY DISCREPANCIES 48-HOURS PRIOR TO COMMENCING WORK.
- ALL CONFLICTING TRAFFIC LINES AND PAVEMENT MARKINGS SHALL BE COMPLETELY REMOVED BY LIGHTLY GRINDING, PLACE TYPE I SLURRY SEAL UPON AFFECTED AREA.
- DEPRESSIONS IN THE PAVEMENT RESULTING FROM THE REMOVAL OF RAISED PAVEMENT MARKERS SHALL BE PATCHED AS NECESSARY TO MATCH THE SURROUNDING SURFACES.
- ALL PAVEMENT MARKINGS (EXCEPT WHERE NOTED OTHERWISE), STRIPING, AND CROSSWALKS, SHALL BE PAINT. REFER TO SPECIFICATIONS.
- CONTRACTOR TO FURNISH AND INSTALL NEW SIGNS, POSTS AND NEW STREET NAME SIGNS, AS NOTED. NEW SIGNS SHALL BE HIGH INTENSITY PRISMATIC SHEETING. NEW SIGN SIZE SHALL MATCH EXISTING.
- ALL NEW SIGN POSTS SHALL BE SQUARE STEEL TUBING WITH METAL DRIVE ANCHORS (2-1/2" SQUARE UNISTRUT TELESPAR TUBING OR APPROVED EQUAL).
- ALL SALVAGED SIGN EQUIPMENT SHALL BE DELIVERED TO THE COUNTY OF KINGS.

SHEET INDEX:

SHEET 1	TITLE SHEET
SHEET 2	22ND AVE AND EXCELSIOR AVE
SHEET 3	12 3/4TH AVE AND EXCELSIOR AVE
SHEET 4	21ST AVE AND FREMONT AVE
SHEET 5	14TH AVE AND FARGO AVE
SHEET 6	17TH AVE AND LACEY BLVD
SHEET 7	16TH AVE AND HANFORD-ARMONA RD
SHEET 8	AVENAL CUTOFF RD AND JACKSON AVE
SHEET 9	18TH AVE AND KANSAS AVE

REVISIONS			
NO.	DESCRIPTION	APP.	DATE

COUNTY OF KINGS

HSIP CYCLE 10
FLASHING BEACONS AT VARIOUS LOCATIONS

TITLE SHEET

DRAWN BY : MT
DESIGNED BY : MT
CHECKED BY : JL

SHT. 1 OF 9 SHTS

PLAN NO.



PLANS PREPARED BY:
WILLDAN Engineering *extending your reach*
13191 CROSSROADS PARKWAY NORTH
SUITE 405 INDUSTRY, CA 91746-3497
(562) 908-6200
UNDER THE SUPERVISION OF
Jeffrey C. Lau
JEFFREY C. LAU RCE 83887 DATE 12/9/2022

APPROVED BY: COUNTY OF KINGS

Michel Cabrera 04/14/23
MITCHEL CABRERA, P.E.
CHIEF ENGINEER - COUNTY OF KINGS DATE

BENCH MARK:

NO. _____ ELEV. _____
DATE ADJ. _____ QUAD. _____

SEE PLAN

SIGNING AND STRIPING CONSTRUCTION NOTES

- 1 INSTALL R1-1 SIGN WITH SOLAR POWERED 24-HOUR FLASHING BEACON PER MODEL R247-F OF CARMANAH TECHNOLOGIES WITH PERFORATED SQUARE POLE MOUNTED AND SINGLE INTEGRATED, ENGINE AND RED BEACON, OR APPROVED EQUAL, PER MANUFACTURER'S SPECIFICATIONS, SEE DETAIL "A" FOR DETAILS.
- 2 INSTALL W3-1 SIGN WITH SOLAR POWERED 24-HOUR FLASHING BEACON PER MODEL R247-F OF CARMANAH TECHNOLOGIES WITH PERFORATED SQUARE POLE MOUNTED AND SINGLE INTEGRATED, ENGINE AND YELLOW BEACON, OR APPROVED EQUAL, PER MANUFACTURER'S SPECIFICATIONS, SEE DETAIL "B" FOR DETAILS.
- 3 PAINT STRIPING DETAIL AND/OR PAVEMENT MARKING AS SHOWN.
- 4 PAINT "STOP AHEAD" PAVEMENT LEGEND.
- 5 REMOVE CONFLICTING STRIPING.
- 6 REMOVE SIGN(S) AND POST AS NOTED.
- 7 INSTALL SIGN(S) AND POST AS NOTED.
- 8 REMOVE SIGN(S) AS NOTED.
- 9 INSTALL SIGN(S) AS NOTED.

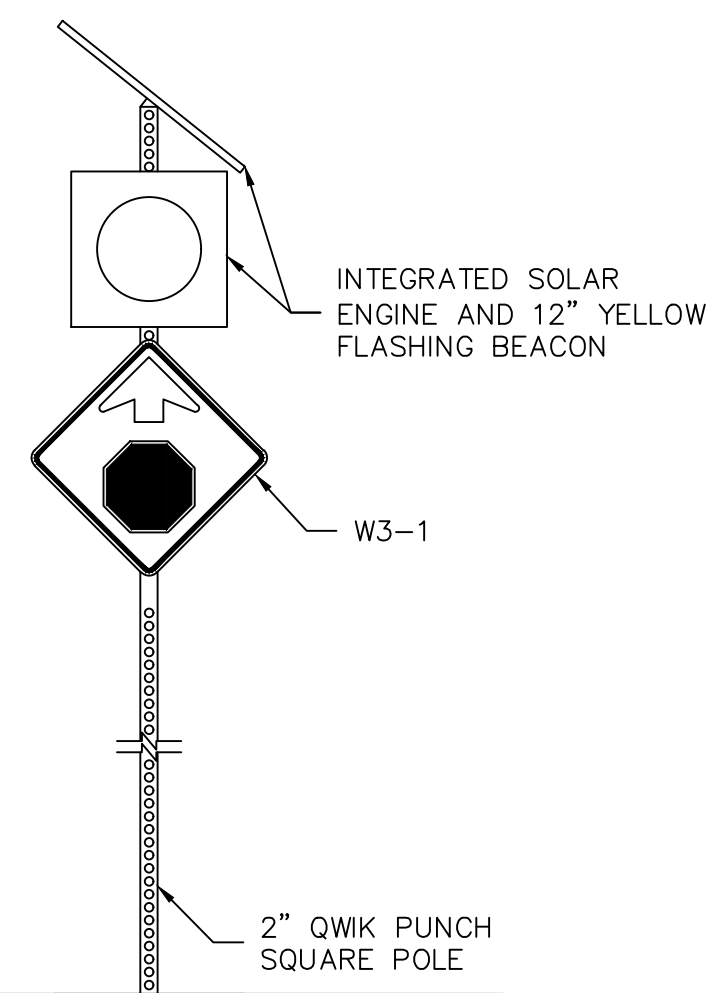
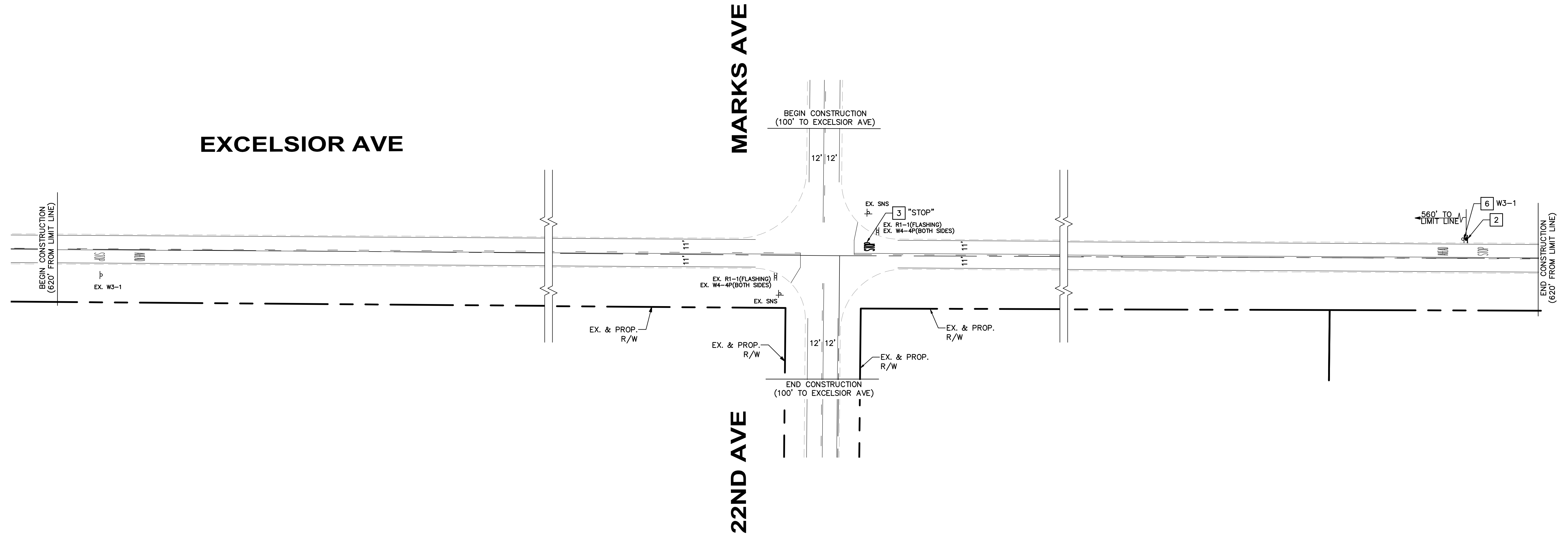

SOLAR YELLOW FLASHING BEACON
DETAIL "B"
 NO SCALE



PLANS PREPARED BY:
WILLDAN Engineering *extending your reach*
 13191 CROSSROADS PARKWAY NORTH
 SUITE 405 INDUSTRY, CA 91746-3497
 (562) 908-6200
 UNDER THE SUPERVISION OF
Jeffrey C. Lau 12/9/2022
 JEFFREY C. LAU RCE 83887 DATE

BENCH MARK:
 NO. _____ ELEV. _____
 DATE ADJ. _____ QUAD. _____
 SEE PLAN

REVISIONS			
NO.	DESCRIPTION	APP.	DATE

COUNTY OF KINGS

FLASHING BEACONS AND STRIPING PLAN
 EXCELSIOR AVE AND 22ND AVE

DRAWN BY : MT	PLAN NO.
DESIGNED BY : MT	SHT. 2 OF 9 SHTS
CHECKED BY : JL	

SIGNING AND STRIPING CONSTRUCTION NOTES

- 1 INSTALL R1-1 SIGN WITH SOLAR POWERED 24-HOUR FLASHING BEACON PER MODEL R247-F OF CARMANAH TECHNOLOGIES WITH PERFORATED SQUARE POLE MOUNTED AND SINGLE INTEGRATED, ENGINE AND RED BEACON, OR APPROVED EQUAL, PER MANUFACTURER'S SPECIFICATIONS, SEE DETAIL "A" FOR DETAILS.
- 2 INSTALL W3-1 SIGN WITH SOLAR POWERED 24-HOUR FLASHING BEACON PER MODEL R247-F OF CARMANAH TECHNOLOGIES WITH PERFORATED SQUARE POLE MOUNTED AND SINGLE INTEGRATED, ENGINE AND YELLOW BEACON, OR APPROVED EQUAL, PER MANUFACTURER'S SPECIFICATIONS, SEE DETAIL "B" FOR DETAILS.
- 3 PAINT STRIPING DETAIL AND/OR PAVEMENT MARKING AS SHOWN.
- 4 PAINT "STOP AHEAD" PAVEMENT LEGEND.
- 5 REMOVE CONFLICTING STRIPING.
- 6 REMOVE SIGN(S) AND POST AS NOTED.
- 7 INSTALL SIGN(S) AND POST AS NOTED.
- 8 REMOVE SIGN(S) AS NOTED.
- 9 INSTALL SIGN(S) AS NOTED.

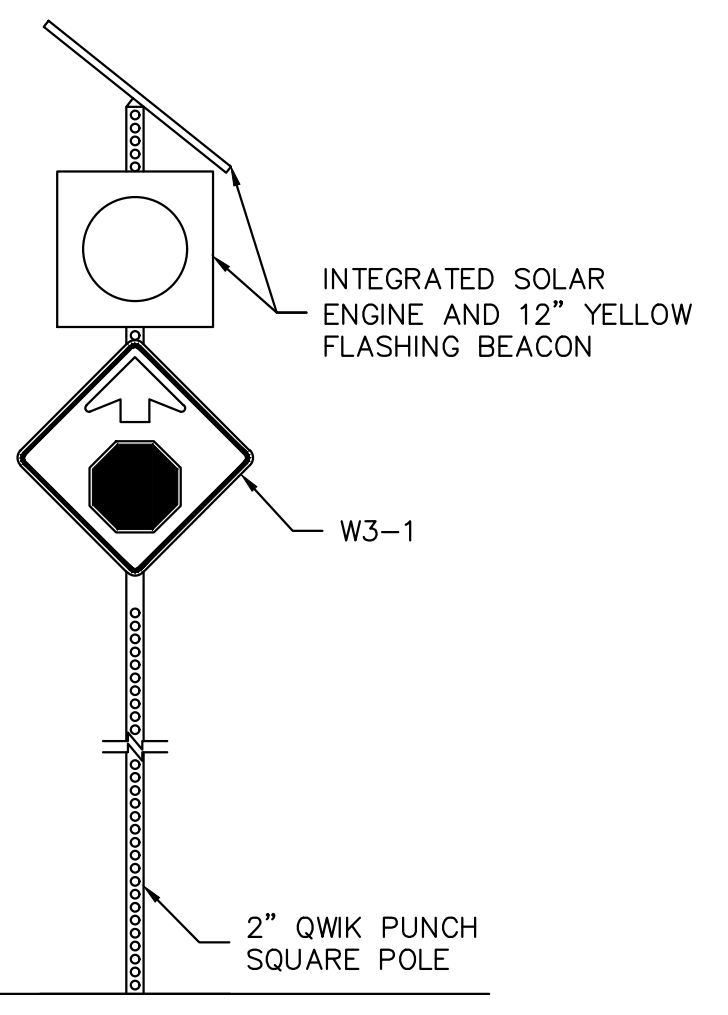
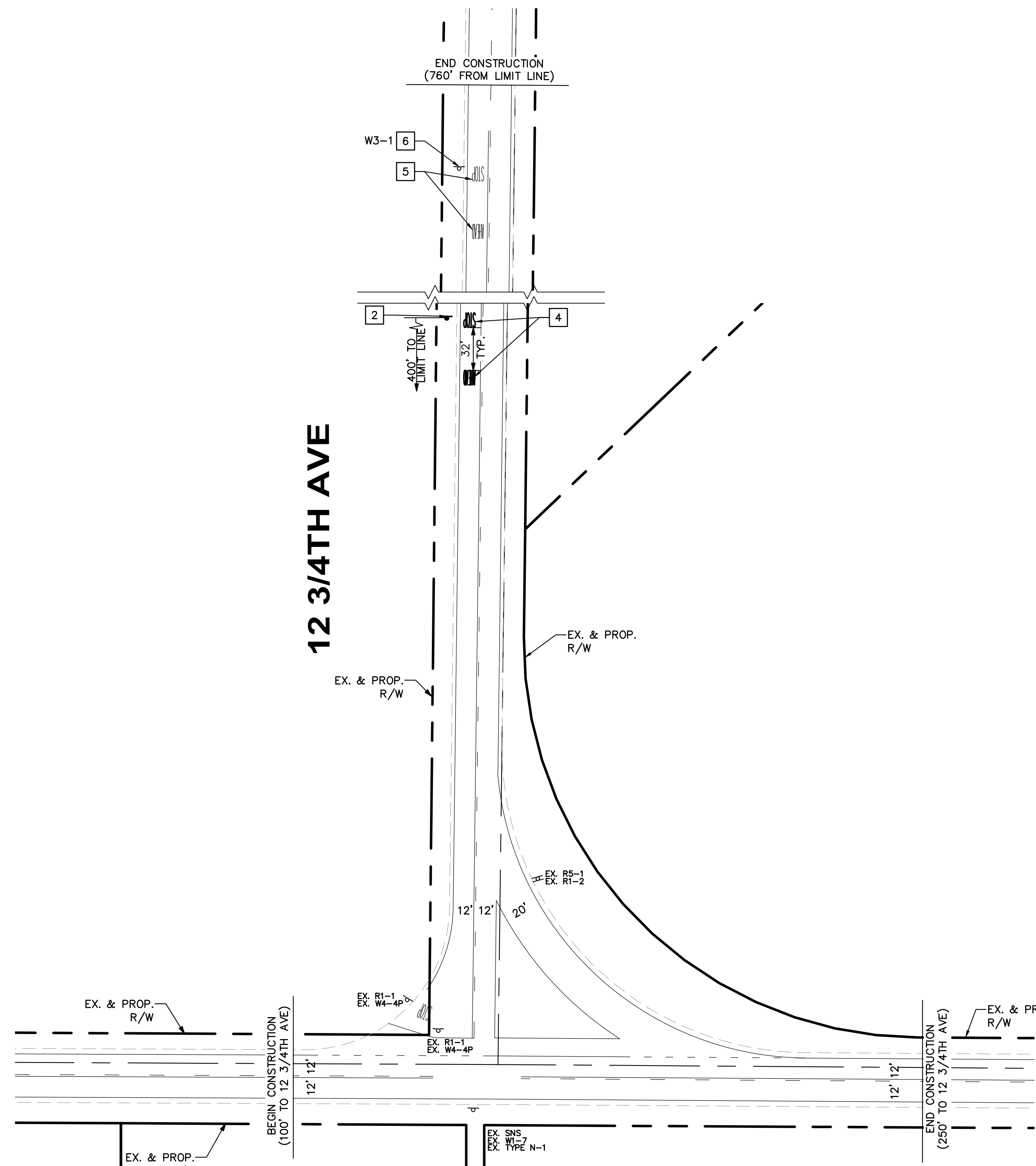

SOLAR YELLOW FLASHING BEACON
DETAIL "B"
 NO SCALE

EXCELSIOR AVE

12 3/4TH AVE



PLANS PREPARED BY:
WILLDAN Engineering *extending your reach*
 13191 CROSSROADS PARKWAY NORTH
 SUITE 405 INDUSTRY, CA 91746-3497
 (562) 908-6200
 UNDER THE SUPERVISION OF
 12/9/2022
 JEFFREY C. LAU RCE 83887 DATE

BENCH MARK:
 NO. _____ ELEV. _____
 DATE ADJ. _____ QUAD. _____
 SEE PLAN

REVISIONS			
NO.	DESCRIPTION	APP.	DATE

COUNTY OF KINGS

FLASHING BEACONS AND STRIPING PLAN
 EXCELSIOR AVE AND 12 3/4TH AVE

DRAWN BY : MT	PLAN NO.
DESIGNED BY : MT	SHT. 3 OF 9 SHTS
CHECKED BY : JL	

SIGNING AND STRIPING CONSTRUCTION NOTES

- 1 INSTALL R1-1 SIGN WITH SOLAR POWERED 24-HOUR FLASHING BEACON PER MODEL R247-F OF CARMANAH TECHNOLOGIES WITH PERFORATED SQUARE POLE MOUNTED AND SINGLE INTEGRATED, ENGINE AND RED BEACON, OR APPROVED EQUAL, PER MANUFACTURER'S SPECIFICATIONS, SEE DETAIL "A" FOR DETAILS.
- 2 INSTALL W3-1 SIGN WITH SOLAR POWERED 24-HOUR FLASHING BEACON PER MODEL R247-F OF CARMANAH TECHNOLOGIES WITH PERFORATED SQUARE POLE MOUNTED AND SINGLE INTEGRATED, ENGINE AND YELLOW BEACON, OR APPROVED EQUAL, PER MANUFACTURER'S SPECIFICATIONS, SEE DETAIL "B" FOR DETAILS.
- 3 PAINT STRIPING DETAIL AND/OR PAVEMENT MARKING AS SHOWN.
- 4 PAINT "STOP AHEAD" PAVEMENT LEGEND.
- 5 REMOVE CONFLICTING STRIPING.
- 6 REMOVE SIGN(S) AND POST AS NOTED.
- 7 INSTALL SIGN(S) AND POST AS NOTED.
- 8 REMOVE SIGN(S) AS NOTED.
- 9 INSTALL SIGN(S) AS NOTED.

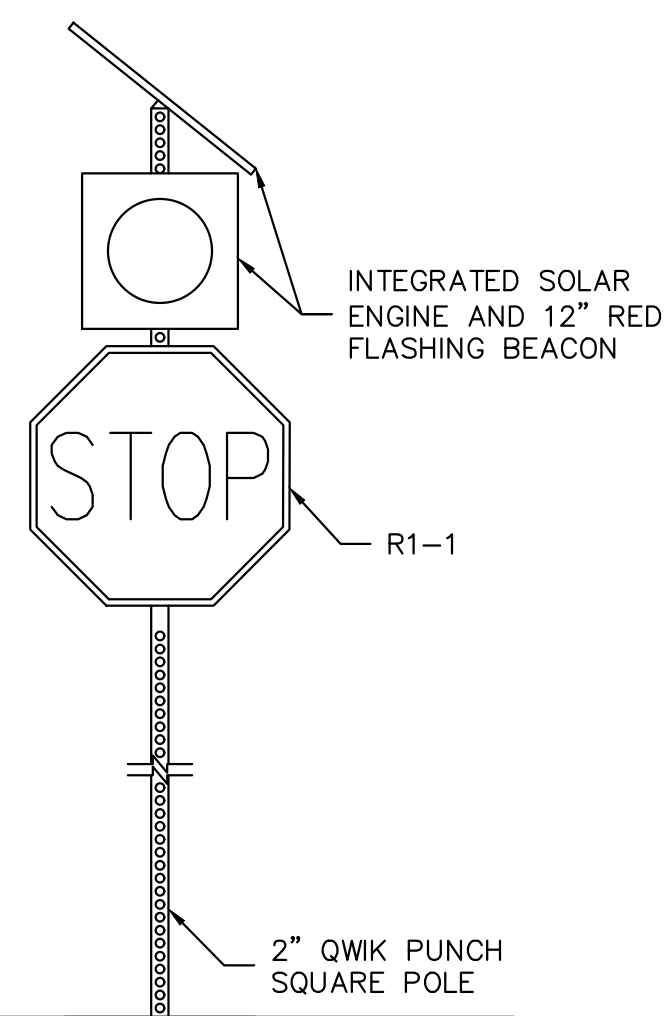
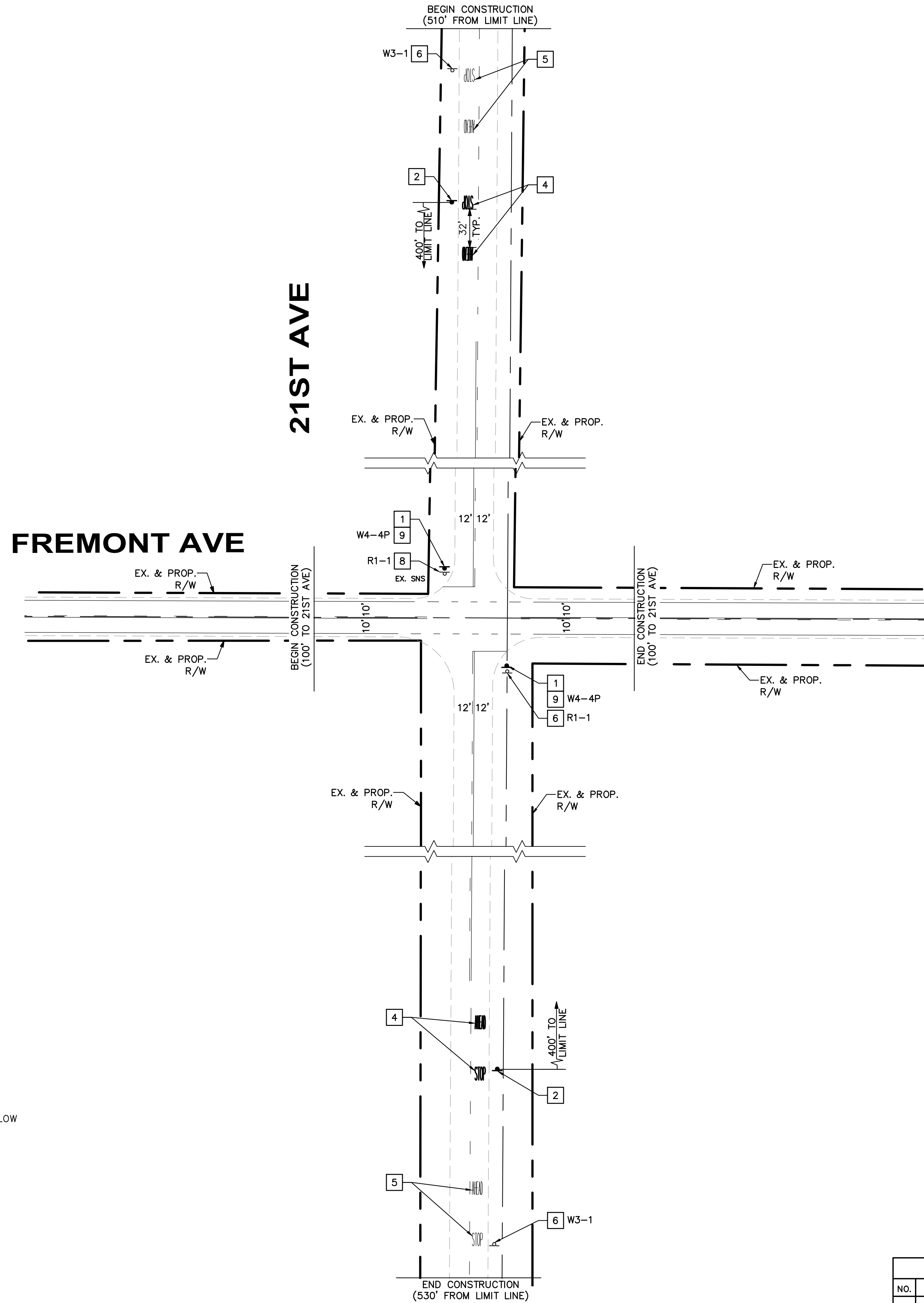

SOLAR RED FLASHING BEACON
DETAIL "A"
NO SCALE

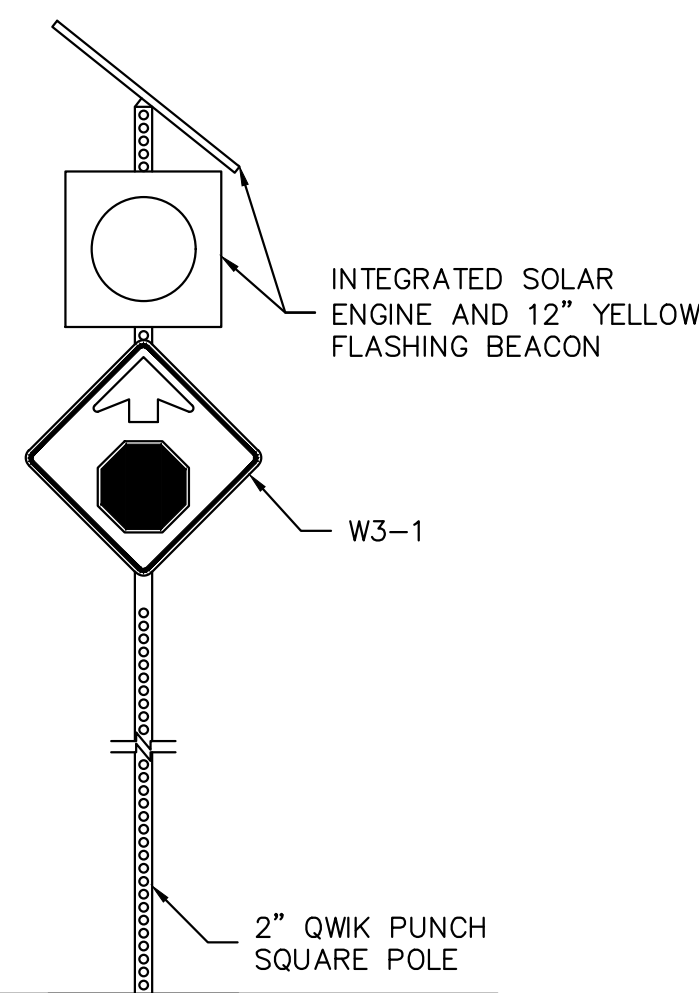

SOLAR YELLOW FLASHING BEACON
DETAIL "B"
NO SCALE



PLANS PREPARED BY:
WILLDAN Engineering *extending your reach*
13191 CROSSROADS PARKWAY NORTH
SUITE 405 INDUSTRY, CA 91746-3497
(562) 908-6200
UNDER THE SUPERVISION OF
Jeffrey C. Lau 12/9/2022
JEFFREY C. LAU RCE 83887 DATE

BENCH MARK:
NO. _____ ELEV. _____
DATE ADJ. _____ QUAD. _____

SEE PLAN

REVISIONS			
NO.	DESCRIPTION	APP.	DATE

COUNTY OF KINGS

FLASHING BEACONS AND STRIPING PLAN
21ST AVE AND FREMONT AVE

DRAWN BY : MT	PLAN NO.
DESIGNED BY : MT	SHT. 4 OF 9 SHTS
CHECKED BY : JL	

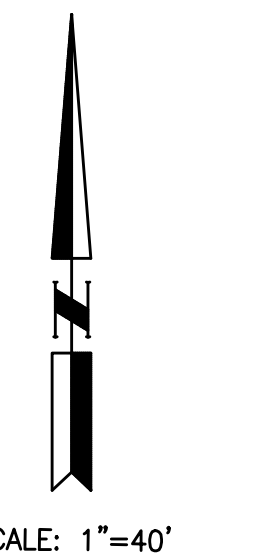

SIGNING AND STRIPING CONSTRUCTION NOTES

- 1 INSTALL R1-1 SIGN WITH SOLAR POWERED 24-HOUR FLASHING BEACON PER MODEL R247-F OF CARMANAH TECHNOLOGIES WITH PERFORATED SQUARE POLE MOUNTED AND SINGLE INTEGRATED, ENGINE AND RED BEACON, OR APPROVED EQUAL, PER MANUFACTURER'S SPECIFICATIONS, SEE DETAIL "A" FOR DETAILS.
- 2 INSTALL W3-1 SIGN WITH SOLAR POWERED 24-HOUR FLASHING BEACON PER MODEL R247-F OF CARMANAH TECHNOLOGIES WITH PERFORATED SQUARE POLE MOUNTED AND SINGLE INTEGRATED, ENGINE AND YELLOW BEACON, OR APPROVED EQUAL, PER MANUFACTURER'S SPECIFICATIONS, SEE DETAIL "B" FOR DETAILS.
- 3 PAINT STRIPING DETAIL AND/OR PAVEMENT MARKING AS SHOWN.
- 4 PAINT "STOP AHEAD" PAVEMENT LEGEND.
- 5 REMOVE CONFLICTING STRIPING.
- 6 REMOVE SIGN(S) AND POST AS NOTED.
- 7 INSTALL SIGN(S) AND POST AS NOTED.
- 8 REMOVE SIGN(S) AS NOTED.
- 9 INSTALL SIGN(S) AS NOTED.

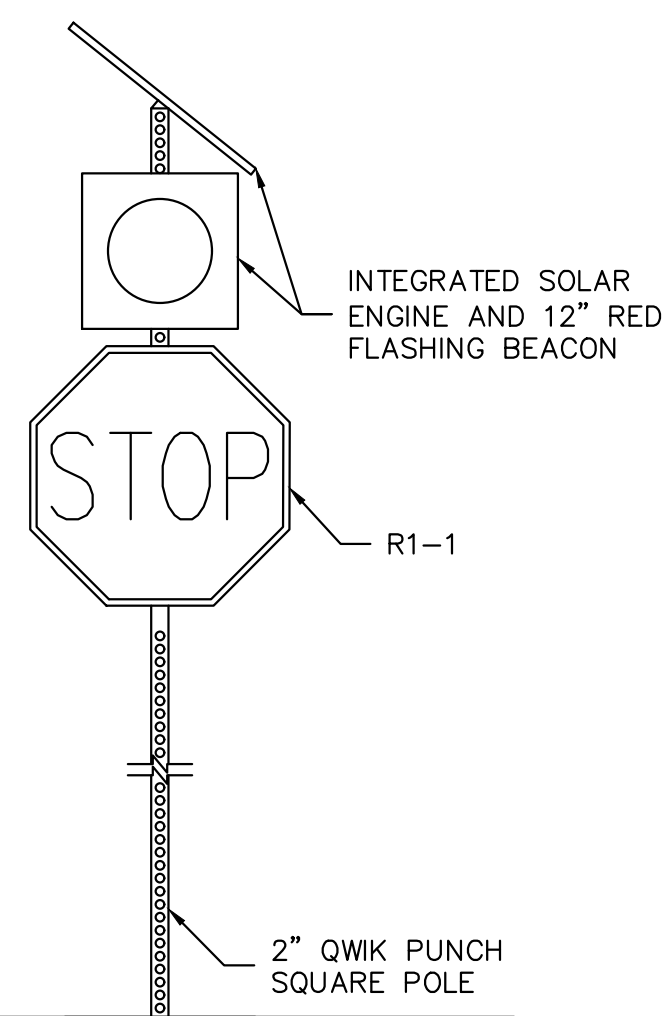
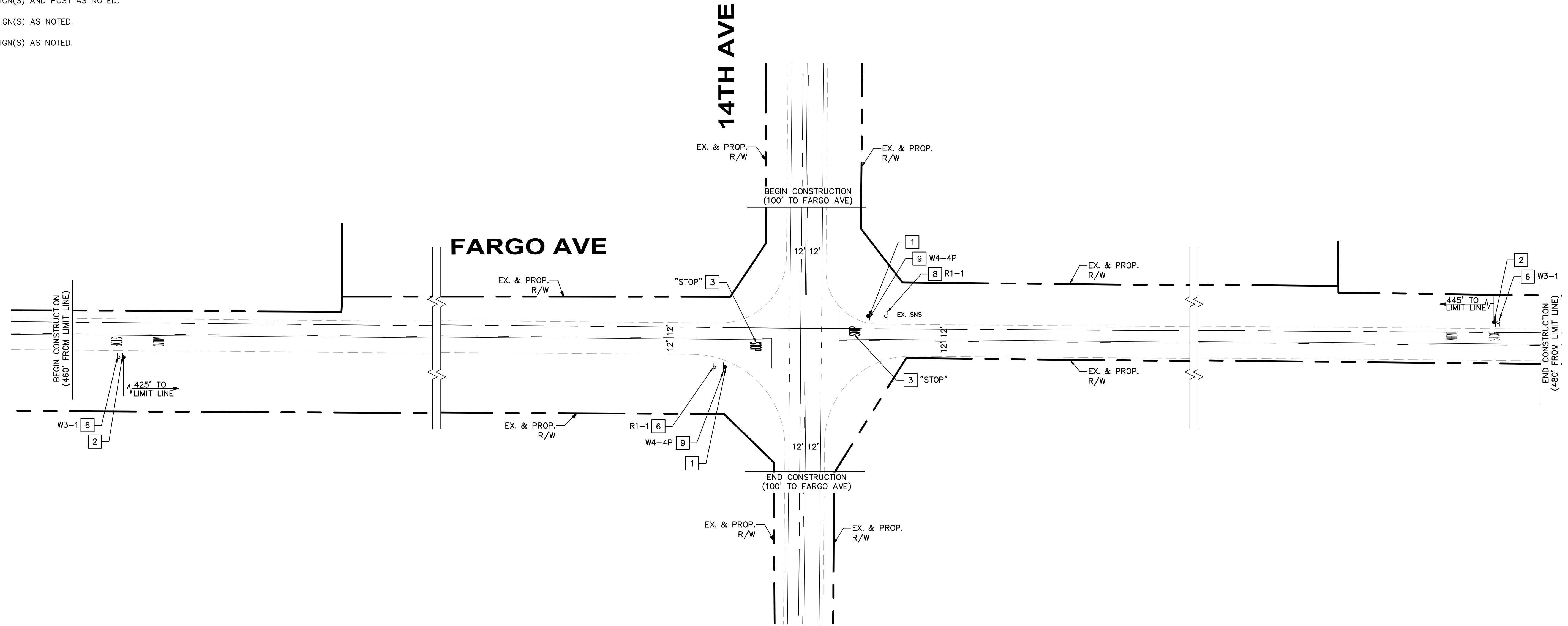

SOLAR RED FLASHING BEACON
DETAIL "A"
NO SCALE

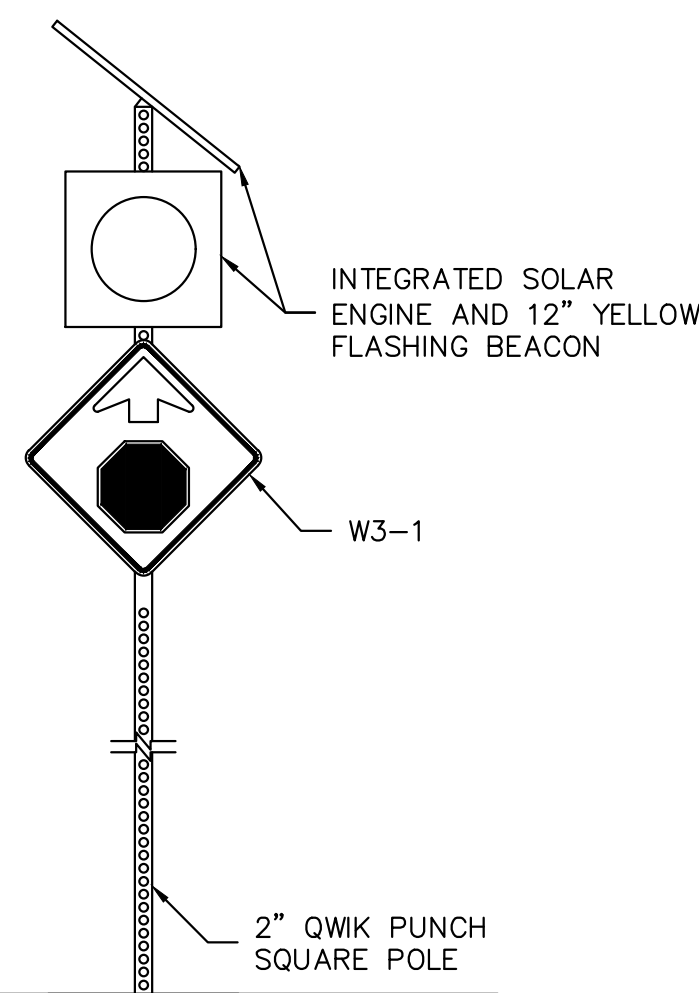

SOLAR YELLOW FLASHING BEACON
DETAIL "B"
NO SCALE



PLANS PREPARED BY:
WILLDAN Engineering *extending your reach*
 13191 CROSSROADS PARKWAY NORTH
 SUITE 405 INDUSTRY, CA 91746-3497
 (562) 908-6200
 UNDER THE SUPERVISION OF
 12/9/2022
 JEFFREY C. LAU RCE 83887 DATE

BENCH MARK:

NO. _____ ELEV. _____
 DATE ADJ. _____ QUAD. _____

SEE PLAN

REVISIONS			
NO.	DESCRIPTION	APP.	DATE

COUNTY OF KINGS

FLASHING BEACONS AND STRIPING PLAN

14TH AVE AND FARGO AVE

DRAWN BY : MT
 DESIGNED BY : MT
 CHECKED BY : JL

SHT. 5 OF 9 SHTS

PLAN NO.

SIGNING AND STRIPING CONSTRUCTION NOTES

- 1 INSTALL R1-1 SIGN WITH SOLAR POWERED 24-HOUR FLASHING BEACON PER MODEL R247-F OF CARMANAH TECHNOLOGIES WITH PERFORATED SQUARE POLE MOUNTED AND SINGLE INTEGRATED, ENGINE AND RED BEACON, OR APPROVED EQUAL, PER MANUFACTURER'S SPECIFICATIONS, SEE DETAIL "A" FOR DETAILS.
- 2 INSTALL W3-1 SIGN WITH SOLAR POWERED 24-HOUR FLASHING BEACON PER MODEL R247-F OF CARMANAH TECHNOLOGIES WITH PERFORATED SQUARE POLE MOUNTED AND SINGLE INTEGRATED, ENGINE AND YELLOW BEACON, OR APPROVED EQUAL, PER MANUFACTURER'S SPECIFICATIONS, SEE DETAIL "B" FOR DETAILS.
- 3 PAINT STRIPING DETAIL AND/OR PAVEMENT MARKING AS SHOWN.
- 4 PAINT "STOP AHEAD" PAVEMENT LEGEND.
- 5 REMOVE CONFLICTING STRIPING.
- 6 REMOVE SIGN(S) AND POST AS NOTED.
- 7 INSTALL SIGN(S) AND POST AS NOTED.
- 8 REMOVE SIGN(S) AS NOTED.
- 9 INSTALL SIGN(S) AS NOTED.

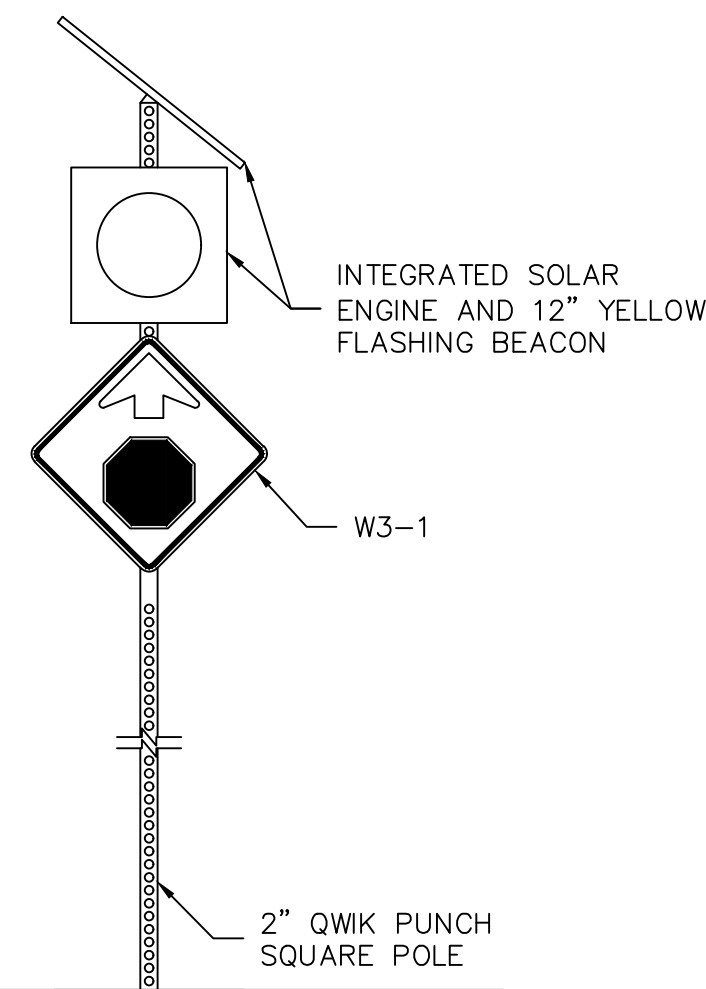
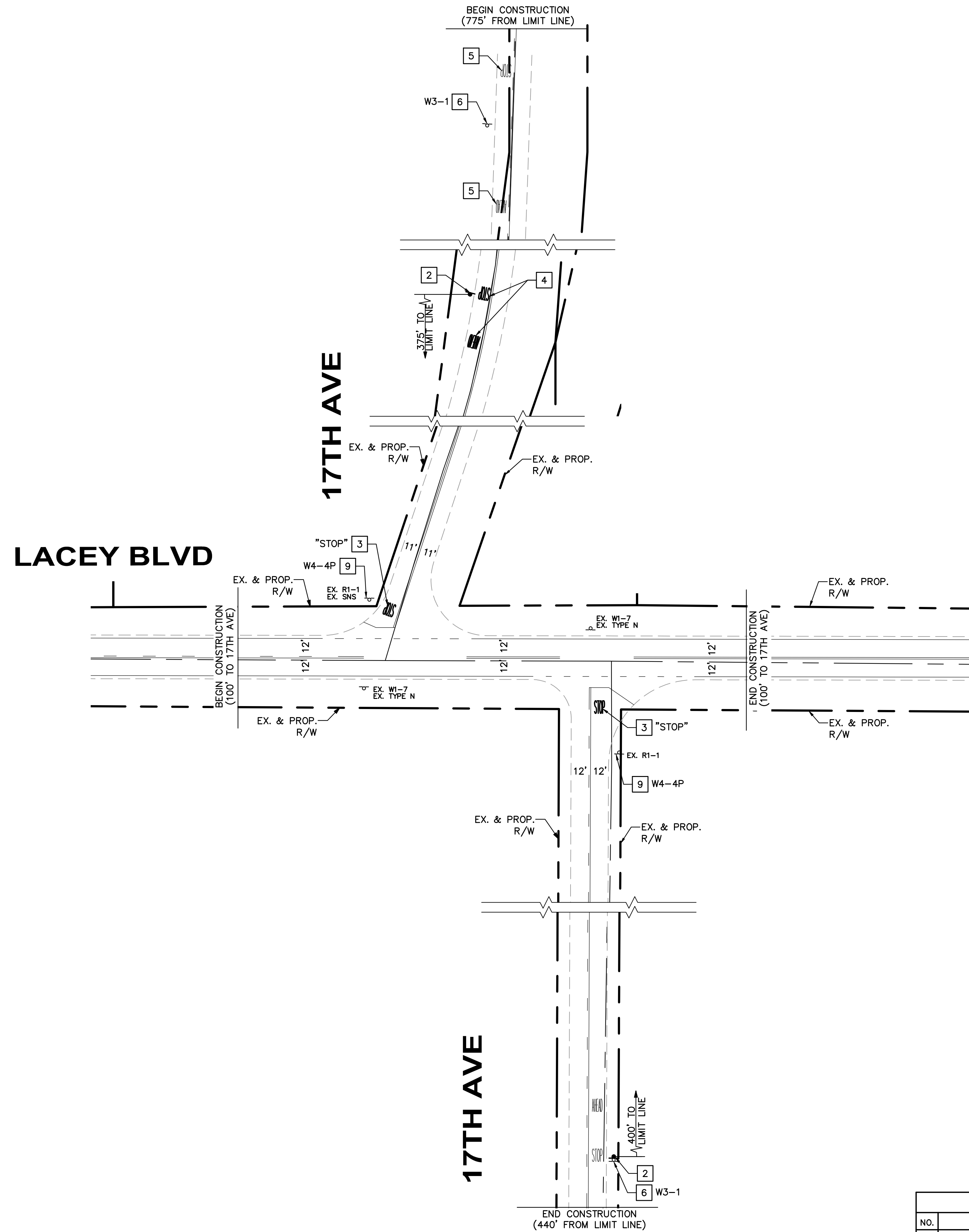

SOLAR YELLOW FLASHING BEACON
DETAIL "B"
 NO SCALE

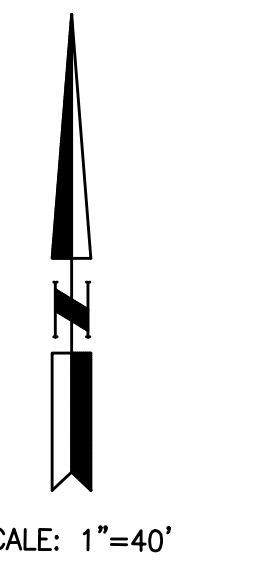

PLANS PREPARED BY:
WILLDAN Engineering *extending your reach*
 13191 CROSSROADS PARKWAY NORTH
 SUITE 405 INDUSTRY, CA 91746-3497
 (562) 908-6200
 UNDER THE SUPERVISION OF
 12/9/2022
 JEFFREY C. LAU RCE 83887 DATE

BENCH MARK:
 NO. _____ ELEV. _____
 DATE ADJ. _____ QUAD. _____
 SEE PLAN

REVISIONS			
NO.	DESCRIPTION	APP.	DATE

COUNTY OF KINGS

FLASHING BEACONS AND STRIPING PLAN
 17TH AVE AND LACEY BLVD

DRAWN BY : MT	PLAN NO.
DESIGNED BY : MT	SHT. 6 OF 9 SHTS
CHECKED BY : JL	

SIGNING AND STRIPING CONSTRUCTION NOTES

- 1 INSTALL R1-1 SIGN WITH SOLAR POWERED 24-HOUR FLASHING BEACON PER MODEL R247-F OF CARMANAH TECHNOLOGIES WITH PERFORATED SQUARE POLE MOUNTED AND SINGLE INTEGRATED, ENGINE AND RED BEACON, OR APPROVED EQUAL, PER MANUFACTURER'S SPECIFICATIONS, SEE DETAIL "A" FOR DETAILS.
- 2 INSTALL W3-1 SIGN WITH SOLAR POWERED 24-HOUR FLASHING BEACON PER MODEL R247-F OF CARMANAH TECHNOLOGIES WITH PERFORATED SQUARE POLE MOUNTED AND SINGLE INTEGRATED, ENGINE AND YELLOW BEACON, OR APPROVED EQUAL, PER MANUFACTURER'S SPECIFICATIONS, SEE DETAIL "B" FOR DETAILS.
- 3 PAINT STRIPING DETAIL AND/OR PAVEMENT MARKING AS SHOWN.
- 4 PAINT "STOP AHEAD" PAVEMENT LEGEND.
- 5 REMOVE CONFLICTING STRIPING.
- 6 REMOVE SIGN(S) AND POST AS NOTED.
- 7 INSTALL SIGN(S) AND POST AS NOTED.
- 8 REMOVE SIGN(S) AS NOTED.
- 9 INSTALL SIGN(S) AS NOTED.

HANFORD ARMONA RD

16TH AVE

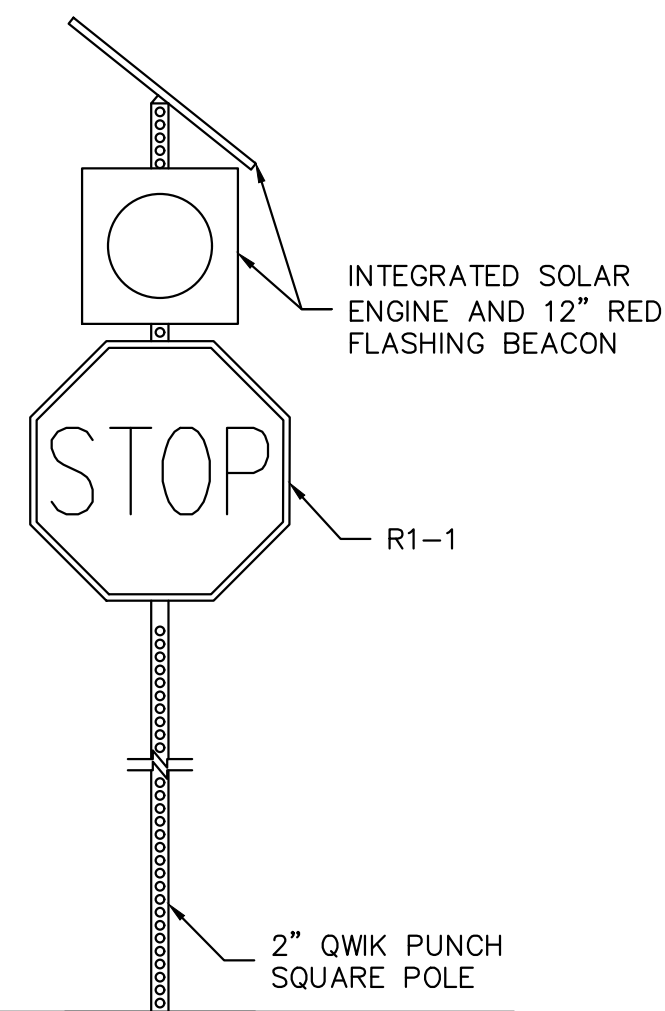
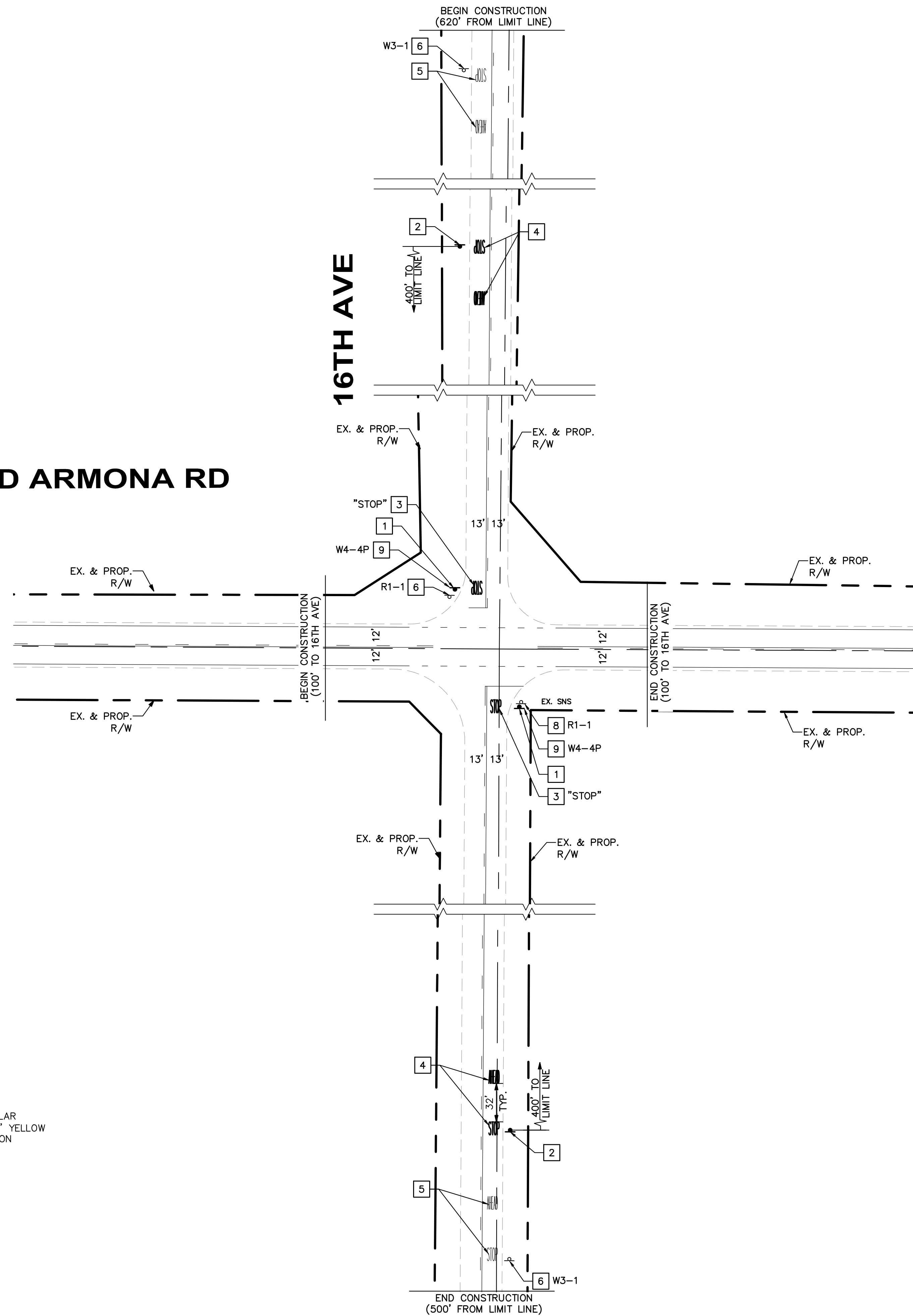

SOLAR RED FLASHING BEACON
DETAIL "A"
NO SCALE

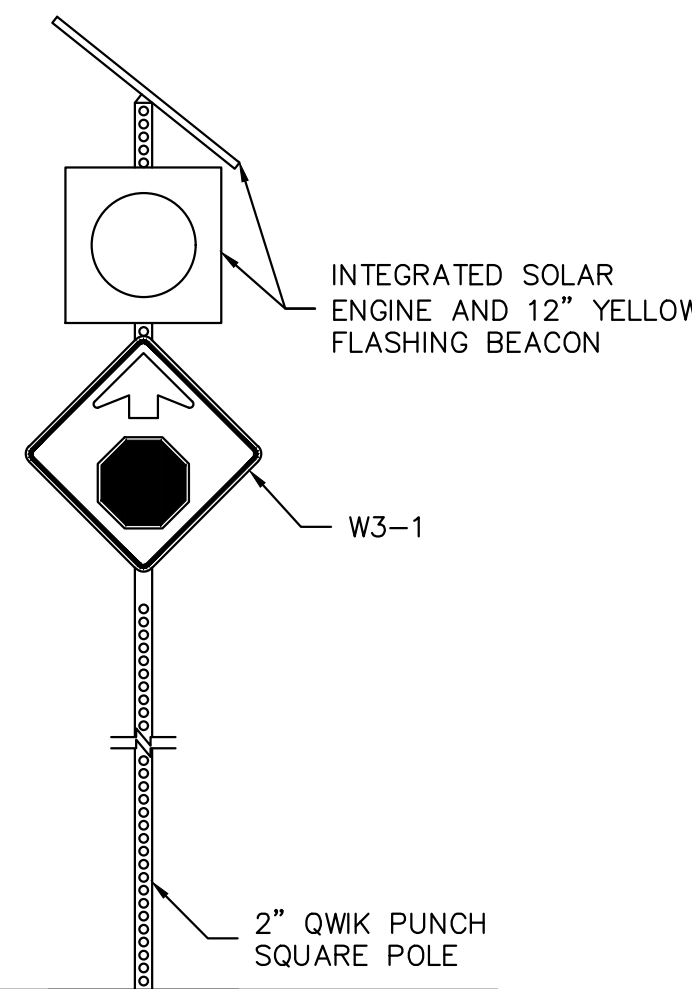

SOLAR YELLOW FLASHING BEACON
DETAIL "B"
NO SCALE



PLANS PREPARED BY:
WILLDAN Engineering *extending your reach*
13191 CROSSROADS PARKWAY NORTH
SUITE 405 INDUSTRY, CA 91746-3497
(562) 908-6200
UNDER THE SUPERVISION OF
Jeffrey C. Lau 12/9/2022
JEFFREY C. LAU RCE 83887 DATE

BENCH MARK:

NO. _____ ELEV. _____
DATE ADJ. _____ QUAD. _____

SEE PLAN

REVISIONS			
NO.	DESCRIPTION	APP.	DATE

COUNTY OF KINGS

FLASHING BEACONS AND STRIPING PLAN

16TH AVE AND HANFORD ARMONA RD

DRAWN BY : MT
DESIGNED BY : MT
CHECKED BY : JL

SHT. 7 OF 9 SHTS

PLAN NO.

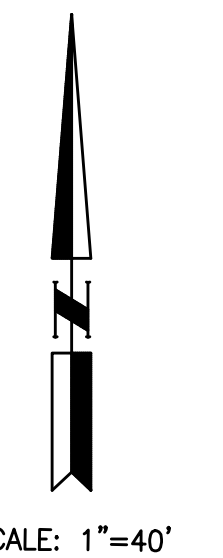

SIGNING AND STRIPING CONSTRUCTION NOTES

- 1 INSTALL R1-1 SIGN WITH SOLAR POWERED 24-HOUR FLASHING BEACON PER MODEL R247-F OF CARMANAH TECHNOLOGIES WITH PERFORATED SQUARE POLE MOUNTED AND SINGLE INTEGRATED, ENGINE AND RED BEACON, OR APPROVED EQUAL, PER MANUFACTURER'S SPECIFICATIONS, SEE DETAIL "A" FOR DETAILS.
- 2 INSTALL W3-1 SIGN WITH SOLAR POWERED 24-HOUR FLASHING BEACON PER MODEL R247-F OF CARMANAH TECHNOLOGIES WITH PERFORATED SQUARE POLE MOUNTED AND SINGLE INTEGRATED, ENGINE AND YELLOW BEACON, OR APPROVED EQUAL, PER MANUFACTURER'S SPECIFICATIONS, SEE DETAIL "B" FOR DETAILS.
- 3 PAINT STRIPING DETAIL AND/OR PAVEMENT MARKING AS SHOWN.
- 4 PAINT "STOP AHEAD" PAVEMENT LEGEND.
- 5 REMOVE CONFLICTING STRIPING.
- 6 REMOVE SIGN(S) AND POST AS NOTED.
- 7 INSTALL SIGN(S) AND POST AS NOTED.
- 8 REMOVE SIGN(S) AS NOTED.
- 9 INSTALL SIGN(S) AS NOTED.

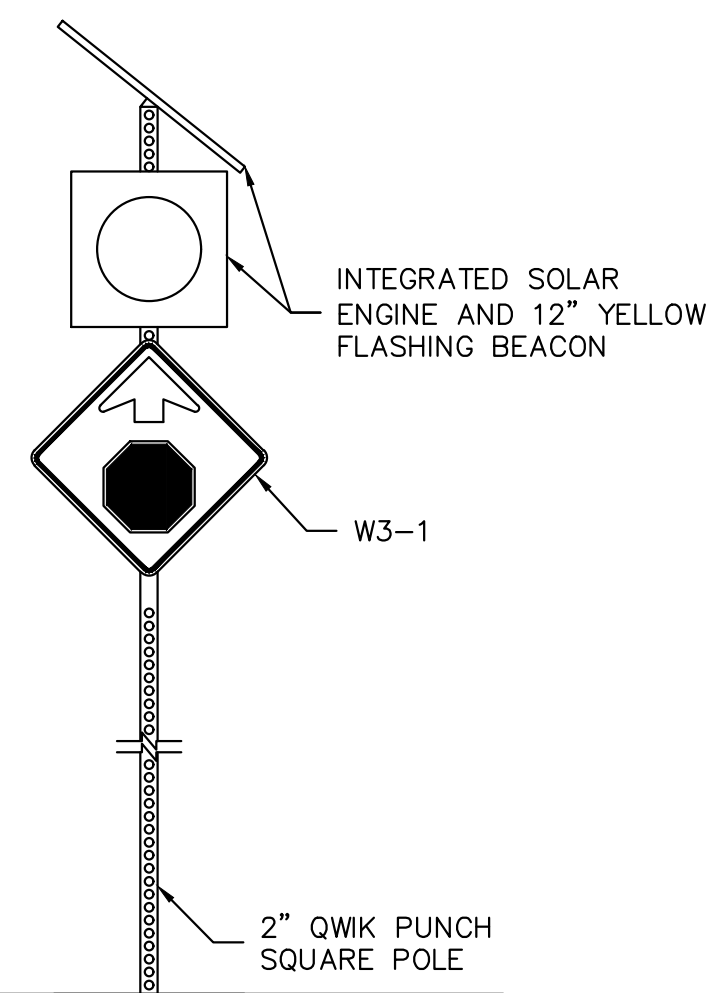
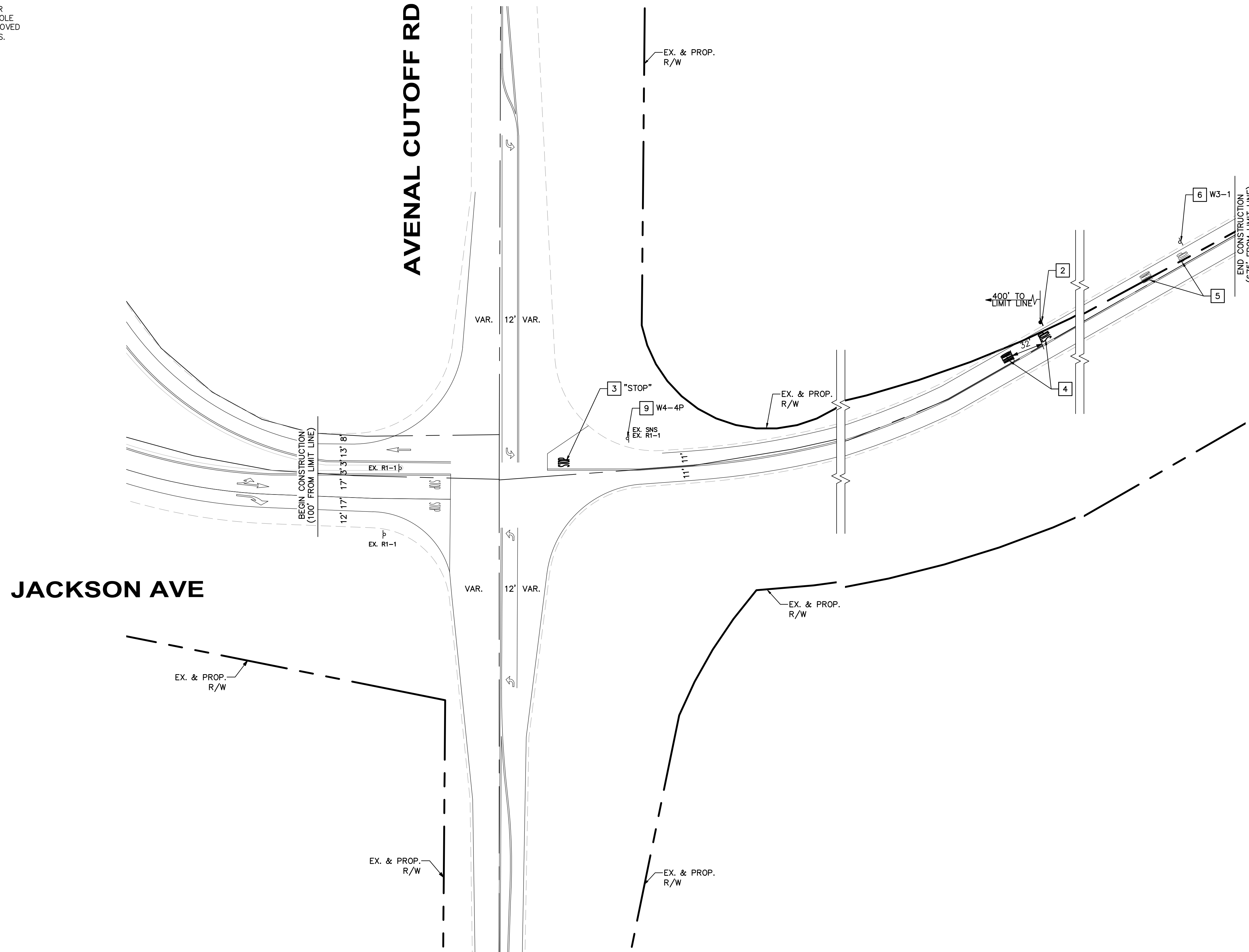

SOLAR YELLOW FLASHING BEACON
DETAIL "B"
 NO SCALE



PLANS PREPARED BY:
WILLDAN Engineering *extending your reach*
 13191 CROSSROADS PARKWAY NORTH
 SUITE 405 INDUSTRY, CA 91746-3497
 (562) 908-6200
 UNDER THE SUPERVISION OF
 12/9/2022
 JEFFREY C. LAU RCE 83887 DATE

BENCH MARK:
 NO. _____ ELEV. _____
 DATE ADJ. _____ QUAD. _____
 SEE PLAN

REVISIONS			
NO.	DESCRIPTION	APP.	DATE

COUNTY OF KINGS

FLASHING BEACONS AND STRIPING PLAN
 AVENAL CUTOFF RD AND JACKSON AVE

DRAWN BY : MT	PLAN NO.
DESIGNED BY : MT	SHT. 8 OF 9 SHTS
CHECKED BY : JL	

SIGNING AND STRIPING CONSTRUCTION NOTES

- 1 INSTALL R1-1 SIGN WITH SOLAR POWERED 24-HOUR FLASHING BEACON PER MODEL R247-F OF CARMANAH TECHNOLOGIES WITH PERFORATED SQUARE POLE MOUNTED AND SINGLE INTEGRATED, ENGINE AND RED BEACON, OR APPROVED EQUAL, PER MANUFACTURER'S SPECIFICATIONS, SEE DETAIL "A" FOR DETAILS.
- 2 INSTALL W3-1 SIGN WITH SOLAR POWERED 24-HOUR FLASHING BEACON PER MODEL R247-F OF CARMANAH TECHNOLOGIES WITH PERFORATED SQUARE POLE MOUNTED AND SINGLE INTEGRATED, ENGINE AND YELLOW BEACON, OR APPROVED EQUAL, PER MANUFACTURER'S SPECIFICATIONS, SEE DETAIL "B" FOR DETAILS.
- 3 PAINT STRIPING DETAIL AND/OR PAVEMENT MARKING AS SHOWN.
- 4 PAINT "STOP AHEAD" PAVEMENT LEGEND.
- 5 REMOVE CONFLICTING STRIPING.
- 6 REMOVE SIGN(S) AND POST AS NOTED.
- 7 INSTALL SIGN(S) AND POST AS NOTED.
- 8 REMOVE SIGN(S) AS NOTED.
- 9 INSTALL SIGN(S) AS NOTED.

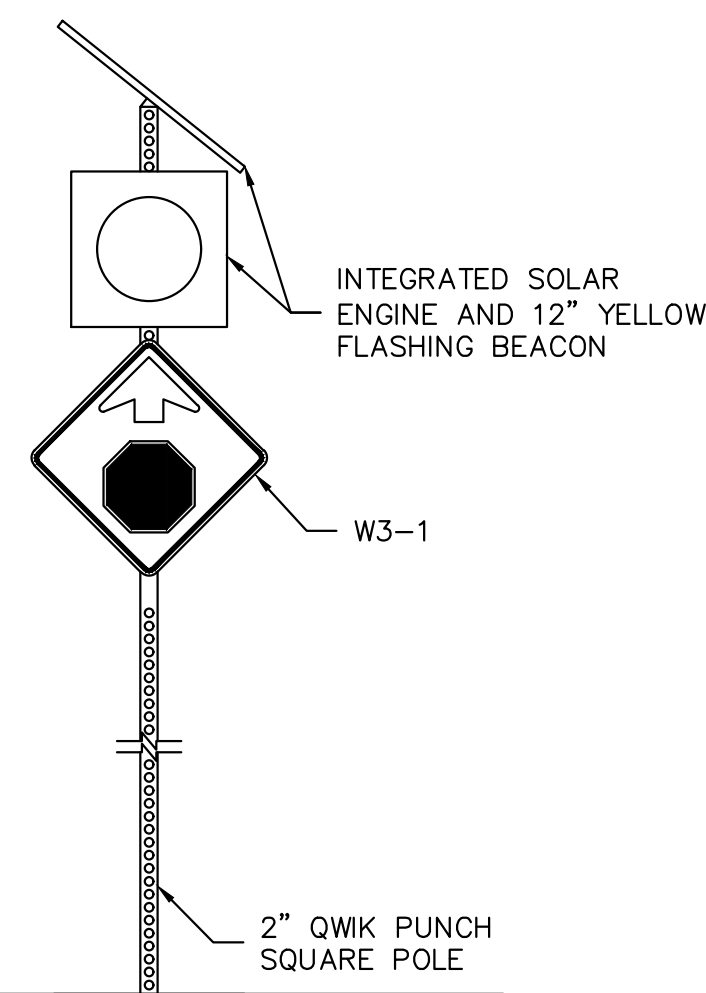
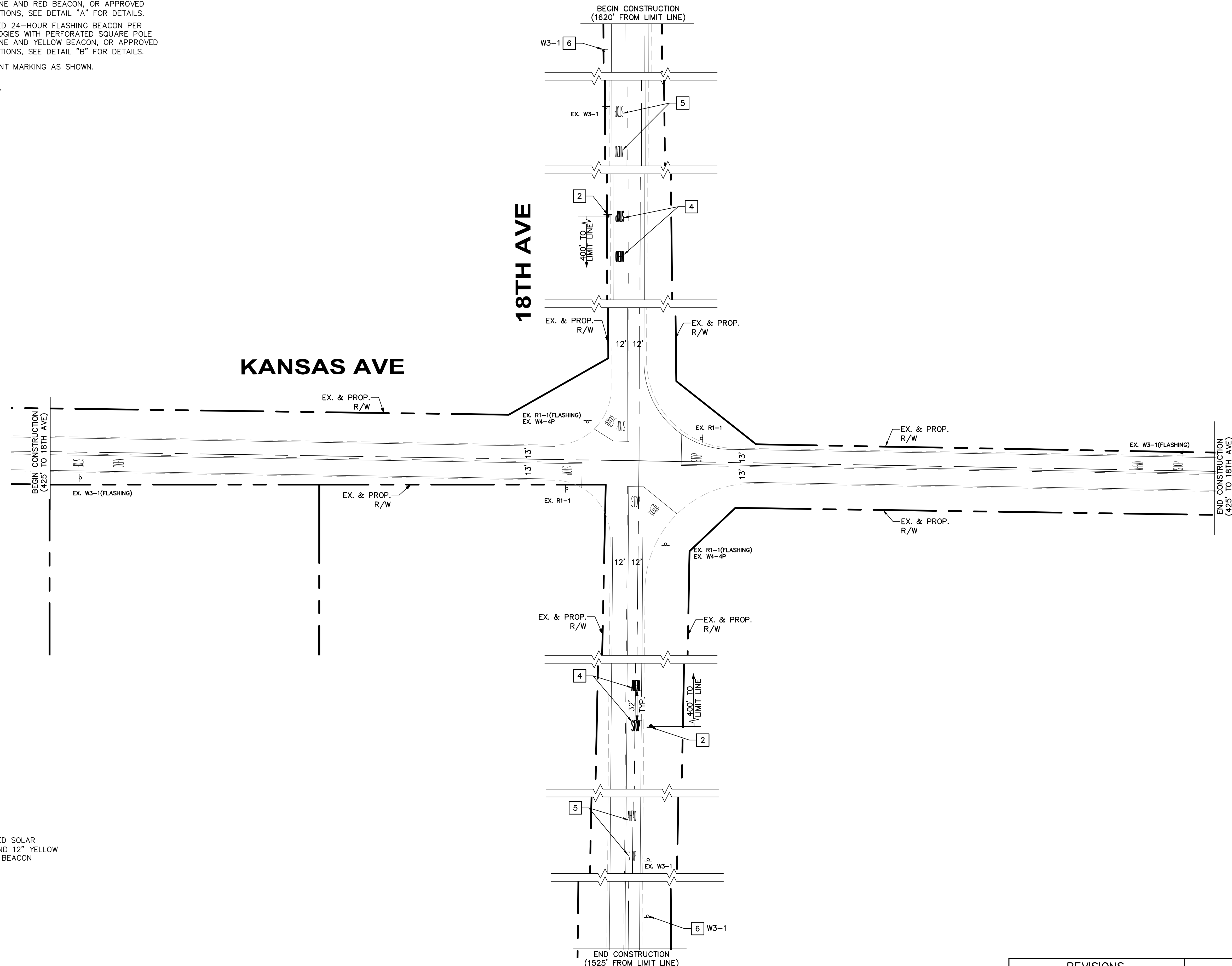

SOLAR YELLOW FLASHING BEACON
DETAIL "B"
 NO SCALE

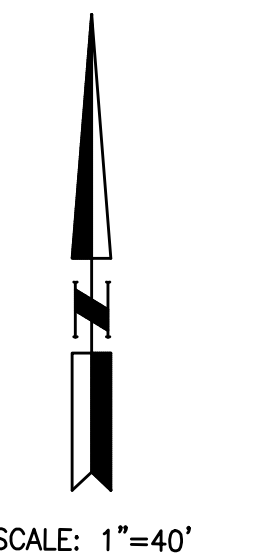

PLANS PREPARED BY:
WILLDAN Engineering *extending your reach*
 13191 CROSSROADS PARKWAY NORTH
 SUITE 405 INDUSTRY, CA 91746-3497
 (562) 908-6200
 UNDER THE SUPERVISION OF
 Jeffrey C. Lau 12/9/2022
 RCE 83887 DATE

BENCH MARK:
 NO. _____ ELEV. _____
 DATE ADJ. _____ QUAD. _____
 SEE PLAN

REVISIONS			
NO.	DESCRIPTION	APP.	DATE

COUNTY OF KINGS

FLASHING BEACONS AND STRIPING PLAN
 18TH AVE AND KANSAS AVE

DRAWN BY : MT	PLAN NO.
DESIGNED BY : MT	SHT. 9 OF 9 SHTS
CHECKED BY : JL	

Directory Path: W:\WE-CA\Kings County of\111591 - Kings County HSP Systemic Safety Improvements\900 PS&E\901 Plans\PL-SS-08.dwg Date: 12/09/22

BID SET